



PRODUCT DATA SHEET

Bonding Adhesive



Features & Benefits

- Coverage rates of 2.35 - 3m²/litre
- Fast Curing
- Available in 1, 2.5 & 5 litre cans
- Up to 15m² coverage per 5 litre container

Description

FIX-R Bonding Adhesive is a high-strength, solvent-based bonding adhesive that allows fast, effective bonding of FIX-R membrane to most building materials.

The bonding adhesive is generally used at angle changes, steep slope and vertical details on the roof. For commercial installations and projects in excess of 100m² the whole roof area should be bonded with FIX-R Bonding Adhesive.

Suitable Surfaces

FIX-R Bonding Adhesive is specially formulated for application with a spreader brush or medium nap roller. This highly versatile adhesive will bond FIX-R EPDM to a large variety of surfaces including brick, render, timber, metals, plastics and approved insulation. Not to be used with expanded polystyrene.

Surface Preparation

- 1) Surfaces should be clean, dry, frost free and free from dust, grease, loose material and other contaminants.
- 2) For timber and composite boards the surface must be sound and not be degraded.
- 3) Stir adhesive before vigorously before use.
- 4) Prolonged job site storage at temperatures in excess of 30°C may affect product shelf life.

Application

- 1) Stir before use, apply using a short pile roller or spreader brush to achieve a thin even coating of adhesive to both surfaces to be mated together. A larger quantity of adhesive may be necessary for open texture and rough surfaces.
- 2) Allow the solvent content to evaporate before bonding the materials. The time for this evaporation will depend on the temperature and humidity. On absorbent or permeable materials such as timber, bonding may be possible within a matter of 2-3 minutes of application; on non-absorbent or non-permeable materials such as metal a minimum of 15 minutes should elapse before the surfaces are bonded.
- 3) The effective open time range will be vary dependant on temperature and ambient conditions. Care should be taken to ensure the adhesive is fully dry before surfaces are mated together.
- 4) Carefully align the surface to be mated, the roof sheet should be pressed onto the surface to be mated. Apply pressure to the surfaces with a roller to ensure full adhesion, smooth membrane and remove any trapped air.
- 5) Trimming of membrane may be commenced immediately.

FIX-R Bonding Adhesive

| | |
|-------------------------|---|
| Base | Polychloroprene Rubber / Phenolic Resin |
| Viscosity | Approx. 6000 – 6500 Cps (at make) |
| Specific Gravity | Approx. 0.8 |
| Colour | Golden brown |
| Tack Life | 2 - 20 mins |
| Flash Point | -22°C |
| Coverage | Approx. 2.35 - 3m ² /ltr |
| Shelf Life | 18 months between 5°C and 25°C |

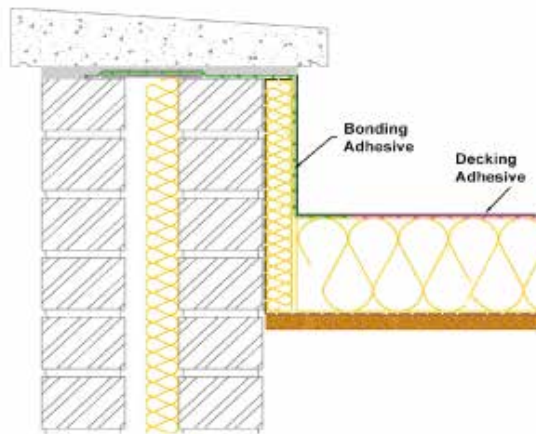

*Simplified installation diagram, not showing RUSS Strip.

Before using this product please ensure that you have been supplied with and have read carefully the following information:

- 1) The product labels
- 2) FIX-R Bonding Adhesive Material Safety Data Sheet

FIX-R

Harding Way,
St Ives,
Cambridgeshire,
PE27 3YJ

Tel: 01480 466777
Fax: 01480 290133

Email: info@fix-r.co.uk
Web: www.fix-r.co.uk