



FLAT ROOFING

## **FIX-R LIQUID ROOFING SPECIFICATION OSB3 Timber Decks**

### **1. Preparation**

Please ensure that the OSB3 Deck is installed according to manufacturer's instructions and good working practice. They must be dry, free from surface dust and other loose material before any further product application.

### **2. General Application**

#### **A. Surface Primer**

FIX-R Liquid Roofing GP Primer must be used at the coverage rate of approx. 0.1ltr per M2. The Primer, when applied, will be a milky white colour and will dry to a translucent finish.

#### **B. FIX-R Liquid Roofing**

In accordance with the minimum coverage rate of 1.2ltr M2, apply approximately one third of the FIX-R Liquid Roofing in manageable sections over the primed substrate as the base layer using a brush or roller. Immediately embed the FIX-R Liquid Roofing Reinforcing Fabric into the base layer and roll the surface with a perlon roller, eliminating potential air bubbles. Overlaps in the reinforcing fabric should be a minimum 75 mm. The remaining two thirds of FIX-R Liquid Roofing must be immediately applied over the reinforcing fabric as the top/ saturation layer (this is known as wet on wet). Roll out evenly until complete saturation is achieved and the weave of the fabric is no longer visible. Ensure the overlap areas (above and below the overlapping fabric) are fully saturated to maintain continuity of the waterproofing system.

### 3. Application Sequence Detail

**1. Roof Deck joints** – Use FIX-R Jointing Tape to cover all joints in the timber deck after the previously applied primer has fully cured to a translucent finish.

**2. Roof Perimeter** - Use 250mm Fabric and FIX-R Liquid Roofing to waterproof the entire roof perimeter (as per application point B above). Continue waterproofing up vertical surfaces a minimum of 150mm above roof finish height, i.e. decking, paving, ballast etc. Application at interfaces with pitched roof elevations should be at a minimum, 300mm up the lay board.

**3. Roof edge trims** - Create the drip and retaining edges to the roof using the appropriate FIX-R GRP Roof Edge Trims after the roof perimeter detailing has been installed as per point 2 above.

**4. Roof Penetrations** - Use 250mm Fabric and FIX-R Liquid Roofing (as per application point B above), seal any items projecting through waterproofing material to render them watertight. Extend waterproofing vertically up penetrations a minimum of 150mm above roof finish height, i.e. decking, paving, ballast etc.

**5. Roof Field** – Use 1m Fabric and FIX-R Liquid Roofing (as per application point B above), reinforce the entire roof field. Remember to overlap adjacent runs of Fabric at a minimum of 75mm.

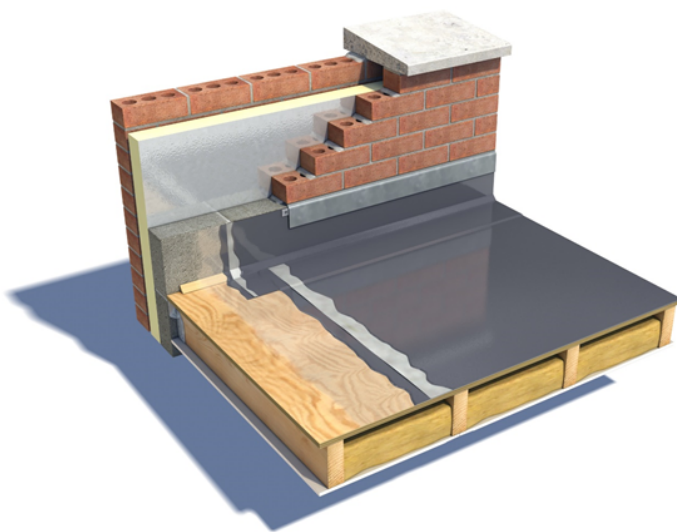

This document should always be read in conjunction with all relevant Product and Safety Data sheets